

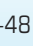

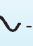

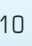

Sirene elettroniche

Electronic sirens

V 12÷24  -48  -110  -240  (±10%)		 50/60 Hz	On 
autoestinguente self-extinguishing	IP 43 	 	°C -30 +50



SE 12/35 MS 32
SE1235MS32

(12) (21) (29)

V 	12÷24
V 	
mA	400 650
dB(A)1m	Min 102 - Max 114 IP 43

SE1235MS321224DA 50424

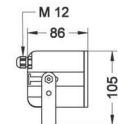
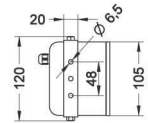

Kg. 0,70



SE 12/36 MS 32
SE1236MS32

(12) (21) (29)

V 	-	-	-
V 	48	110	240
mA	200	90	60
dB(A)1m	Min 108 - Max 113	IP 43	

SE1236MS3248A 50425
SE1236MS32110A 50426
SE1236MS32240A 50427

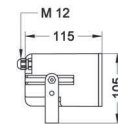
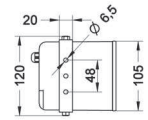

Kg. 1,00



SE PZ/35 MS 32
SEPZ35MS32

(12) (21) (29)

V 	12÷24
V 	
mA	530 240
dB(A)1m	Min 98 - Max 106 IP 43

SEPZ35MS321224DA 50428

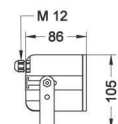
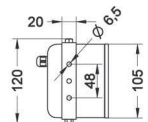

Kg. 0,40



SE PZ/36 MS 32
SEPZ36MS32

(12) (21) (29)

V 	-	-	-
V 	48	110	240
mA	80	35	15
dB(A)1m	Min 99 - Max 104	IP 43	

SEPZ36MS3248A 50429
SEPZ36MS32110A 50430
SEPZ36MS32240A 50431

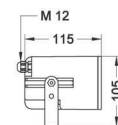
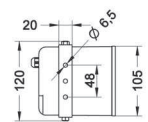

Kg. 0,70

Sirene elettroniche con frontale luminoso

Electronic sirens with lighted front



SEP LD85 MS 32
SEPLD85MS32

(12) (21)

V $\overline{\sim}$ -110 \sim -240 \sim ($\pm 10\%$)	$\overline{\sim}$	\sim 50/60 Hz	On ∞
autoestinguente self-extinguishing	IP 65		$^{\circ}\text{C}$ -30 +50

V $\overline{\sim}$	24	-	-
V \sim		110	240
mA	650	90	60
dB(A)1m	Min 107 - Max 114		

SEPLD85MS3224DA	50901
SEPLD85MS32110A	50903
SEPLD85MS32240A	50904

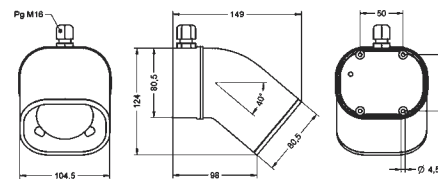

Kg. 0,98
24V: Kg. 0,75



SEP LD85 MS 32 PZ
SEPLD85MS32PZ

(12) (21)

V $\overline{\sim}$	24	-	-
V \sim		110	240
mA	240	35	15
dB(A)1m	Min 98 - Max 106		

SEPLD85MS32PZ24DA	50911
SEPLD85MS32PZ110A	50913
SEPLD85MS32PZ240A	50914

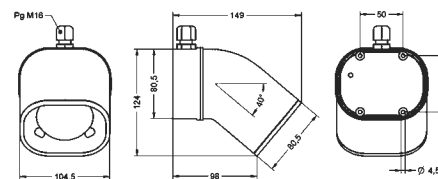

Kg. 0,52
24V: Kg. 0,41

Ronzatori multifunzione (suono/luce)

Multifunction buzzers (sound/light)



BIMF 5T 2B
BIMF5T2B

(49) (50)

BIMF5T2B12240DA 38030



R BIMF 5T 2B
RBIMF5T2B

(49) (50)

RBIMF5T2B12240DA 38032

V 12-24-48-110-240 ($\pm 10\%$)	$\overline{\sim}$	\sim 50/60 Hz	On ∞
autoestinguente self-extinguishing	IP 55		$^{\circ}\text{C}$ -30 +50

V $\overline{\sim}$	12 \div 24 \div 48 \div 110 \div 240				
V \sim					
mA	25	12	12	10	13
dB(A)1m	85	85	85	85	85
Hz	2500 \pm 500				

N°	1	2	Suono Intermittente Lento Slow Intermittent Sound
ON			
OFF	X	X	

N°	1	2	Suono Intermittente Veloce Fast Intermittent Sound
ON	X		
OFF		X	

N°	1	2	Suono Continuo Continuous Sound
ON		X	
OFF	X		
N°	1	2	
ON	X	X	
OFF			

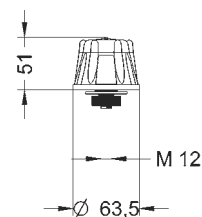

Kg. 0,102

Installazione ad incasso foro \varnothing 12 mm. Fornito adattatore per foro \varnothing 16 mm - \varnothing 22 mm
Flush mounting with openings \varnothing 12 mm. Supplied with adapter for openings \varnothing 16 mm - \varnothing 22 mm